

DWG. NO. 900-165-537

POLARITY SENSOR

Thermostat RELAY CONNECTOR
 RECEPTACLE HOUSING: 5557-02R
 PLUG HOUSING : 5559-02P
 FROM MOLEX. JAPAN CO., LTD

POLARITY SENSOR AND
 THERMOSTAT CABLE
 UL20276, AWG28

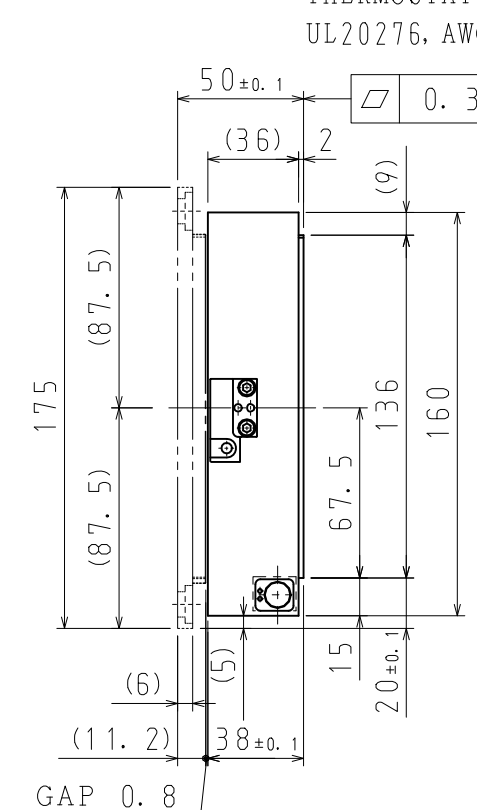

2x#4-40
 UNC SCREWS

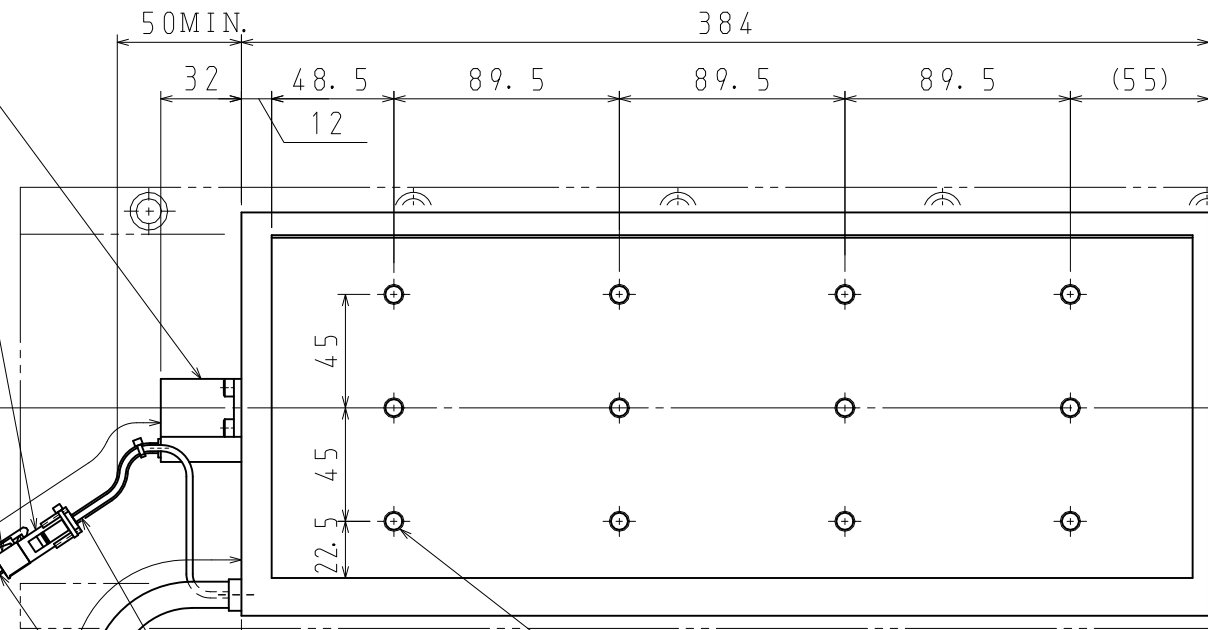

NAMEPLATE

POLARITY SENSOR AND
 THERMOSTAT CONNECTOR

SERVOMOTOR CONNECTOR

500±50
 THERMOSTAT CABLE
 UL1333, AWG20
 THERMOSTAT RELAY CABLE
 UL1333, AWG22
 SERVOMOTOR MAIN CIRCUIT CABLE
 UL2586, AWG12

SEE NOTE. 4



MAGNETIC WAY
 900-120-827

POLARITY SENSOR AND THERMOSTAT CONNECTOR SPECIFICATIONS

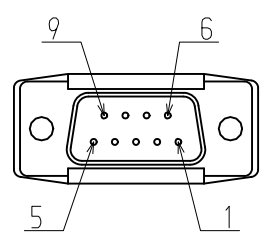

PIN NO.	SIGNAL
1	+5V (THERMOSTAT) +5V (POWER SUPPLY)
2	Su
3	Sv
4	Sw
5	0V (POWER SUPPLY)
6	-
7	-
8	-
9	THERMOSTAT

SERVOMOTOR CONNECTOR SPECIFICATIONS

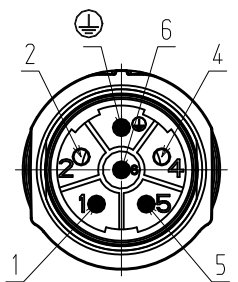

PIN NO.	SIGNAL
1	PHASE V
2	-
4	-
5	PHASE U
6	PHASE W
⊕	F G
CASE	SHIELD

CONNECTOR: SF-5EP1N8A90A2 (1605496)
 CONTACT: SF-7MP2000 (1605626)
 FROM PHOENIX CONTACT GMBH & CO. KG

PIN CONNECTOR: 17JE-23090-02 (D8C) -CG
 FROM DDK LTD.
 MATING CONNECTOR

SOCKET CONNECTOR: 17JE-13090-02 (D8C) A-CG
 STUDS: 17L-002C OR 17L-002C1

MOVING COIL MODEL	RATED FORCE [N]	PEAK FORCE [N]	APPROX. MASS [kg]	CHARACTERISTICS
SGLFW2-1DD380AS1E	1680	5040	14.6	900-126-488

POLARITY SENSOR OUTPUT SIGNALS

THE FOLLOWING FIGURES SHOW THE RELATIONSHIP BETWEEN THE Su, Sv, AND Sw POLARITY SENSOR OUTPUT SIGNALS AND THE INVERSE POWER OF EACH MOTOR PHASE Vu, Vv, AND Vw WHEN THE MOVING COIL MOVES IN THE DIRECTION INDICATED BY THE ARROW IN THE DIMENSIONAL DRAWINGS OF THE MOVING COIL.

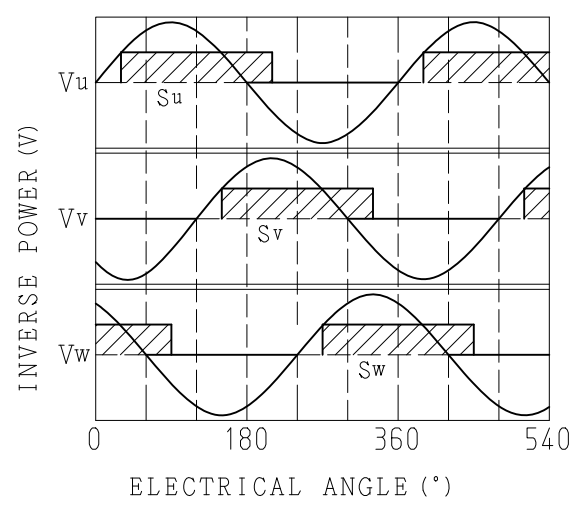

NOTES

- ALL DIMENSIONS ARE IN mm.
- THIS DRAWING IS FOR COIL ASSEMBLY ONLY.
- MOTOR MATING CONNECTOR AND POLARITY SENSOR MATING CONNECTOR ARE NOT INCLUDED.
- THE MOVING COIL MOVES IN THE DIRECTION INDICATED BY THE ARROW WHEN CURRENT FLOWS IN THE FOLLOWING PHASE SEQUENCE: U, V, W.

	DRAW. 14-11-20 T. Imai	TITLE DIMENSION OF LINEAR SERVOMOTOR SGLFW2-1DD380AS1E	DWG. NO. 900-165-537	REV.
	CHECK. K. Watanabe			
	APPR. K. Shiraishi			
SCALE 1:3	SIZE A3			